

BYTUM LIQUID | REINFORCEMENT

CE
EN 1504-2
EN 14891
EN 15814

SPREADABLE WATERPROOF SHEATH | REINFORCING LAYER



CAN BE
PLASTERED



LOW
TEMPERATURE



DURABILITY



BITUMEN
BASED

VERSATILE

Multipurpose waterproof product made from bitumen, selected elastomeric resins and special additives. Thanks to its unique composition, it is both paintable and suitable for use as an underfloor waterproof solution.

REINFORCEABLE

When used with REINFORCEMENT, BYTUM LIQUID is also effective for vertical applications, high-stress supports and surfaces larger than 10 m².



COMPOSITION - REINFORCEMENT

- ① non-woven PL fabric

CODES AND DIMENSIONS

BYTUM LIQUID

CODE	content [kg]	content [lb]	colour (wet/dry)	
BYTL10	10	22	black/grey	24

BYTUM REINFORCEMENT

CODE	H [m]	L [m]	A [m ²]	H [ft]	L [ft]	A [ft ²]	
BYTR	1	50	50	3	164	538	24



DURABLE

Its special formula provides excellent elasticity and waterproofing properties. BYTUM LIQUID provides long-lasting performance with excellent resistance to water stagnation, weathering and UV rays.

TECHNICAL SPECIFICATIONS | BYTUM LIQUID

Properties	standard	value	USC units
Classification ⁽¹⁾	EN 1504-2	C PR-PI-MC-IR	-
Classification ⁽²⁾	EN 14891	DM O1	-
Density	EN ISO 2811-1	approx. 1,5 kg/L	15.03 lb/gal
Maximum applicable thickness (in two layers) ⁽³⁾	-	3 mm	118 mil
Dry residue (m/m a 130 °C)	EN ISO 3251	approx. 77%	-
Time required for application of each layer on the previous one 23 °C/50% RH ⁽⁴⁾	-	24 h	-
Time required for drying 23 °C/50% RH ⁽⁴⁾	-	48 h	-
Resistance to temperature	-	-30/+80 °C	-22/+176 °F
Application temperature (product, ambient and support)	-	+5/+35 °C	+41/+95 °F
Reaction to fire	EN 13501-1	E	-
Brookfield viscosity	EN ISO 3219	65000 ± 13000 cP	-
pH	-	approx. 7,5	-
Direct traction adhesion on timber/metal	EN 1542	1,70 N/mm ²	246.56 psi
Flexibility at low temperatures	EN 1109	-10 °C	-
Elongation at failure	EN 12311-1	> 200%	-
CO ₂ permeability S _d	EN 1062-6	> 50 m	-
Material yield per 1 mm thickness	-	1,5 kg/m ²	-
Water vapour transmission Sd ⁽⁵⁾	EN ISO 7783	I class: < 5 m	-
Free water permeability	EN 1062-3	w < 0,1 kg/m ² ·h ^{0,5}	-
Abrasion resistance (Taber test)	EN ISO 5470-1	< 3 g	-
Impact resistance	EN ISO 6272-1	III class (≥ 20 Nm)	-
Crack bridging ability (method A)	EN 1062-7	A5 class (≥ 10 mm)	-
Tensile adhesion after immersion in water	EN 14891	> 0,5 N/mm ²	> 75.52 psi
Tensile adhesion after thermal ageing	EN 14891	> 0,5 N/mm ²	> 75.52 psi
Tensile adhesion after freeze-thaw cycles	EN 14891	> 0,5 N/mm ²	> 75.52 psi
Tensile adhesion after contact with lime water	EN 14891	> 0,5 N/mm ²	> 75.52 psi
Watertightness	EN 14891	compliant	-
Storage temperature ⁽⁶⁾	-	≥ +5 °C	≥ +41 °F

⁽¹⁾ C PR-PI-MC-IR protective surface coating.

⁽²⁾ Water-based DM O1 waterproofing product applied liquid in dispersion with improved crack bridging capability and at low temperature (-5°C) greater than 0,5 N/mm².

⁽³⁾ On surfaces larger than 10 m², apply REINFORCEMENT on the first wet layer. Wait until completely dry before applying the second layer.

⁽⁴⁾ The data expressed may vary depending on the thickness of the product applied and the specific installation conditions: temperature, humidity, ventilation, absorptivity of the substrate.

⁽⁵⁾ Average value that varies depending on the desired thickness of the layer.

⁽⁶⁾ Store the product in a dry, covered location in its original sealed container (frost sensitive).

 Waste classification (2014/955/EU): 16 03 06.

TECHNICAL DATA | BYTUM REINFORCEMENT

Properties	standard	value	USC units
Mass per unit area	EN 29073-1	100 g/m ²	0.33 oz/ft ²
Thickness	EN 29073-2	0,5 mm	19.69 mil
Tensile strength MD/CD	EN 29073-3	335/300 N/50 mm	38/38 lbf/in
Tear strength	DIN 53363	145 N	33 lbf
Resistance to nail tearing	EN 12310	170 N	38 lbf

RELATED PRODUCTS



MARLIN, CUTTER
page 394



BLACK BAND
page 144



BYTUM SPRAY
page 48



GROUND BAND
page 32

RECOMMENDATIONS FOR INSTALLATION

WATERPROOFING OF WALL-TO-CEILING CORNERS

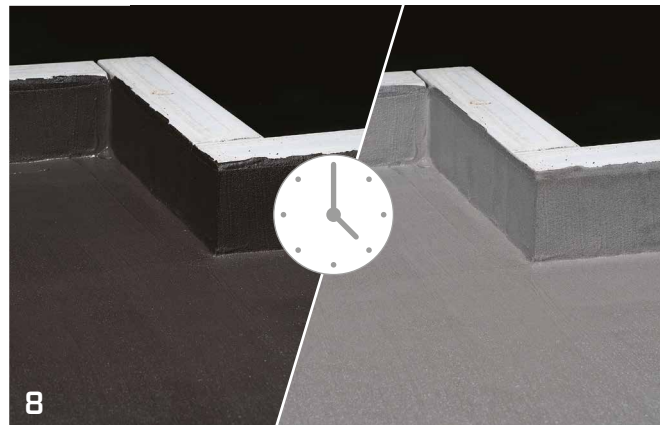
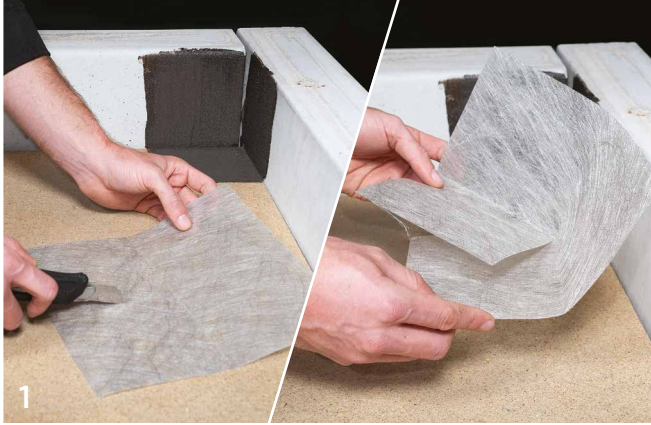

1 MARLIN, CUTTER