

## REUSABLE LIFTING BELT FOR TRANSPORT WALLS AND PRECAST ELEMENTS

- Polyester belt, available in two lengths and two capacities
- Safety factor 7:1, capacity up to 1250 kg | 2750 lbs
- Reusable until signs of wear appear

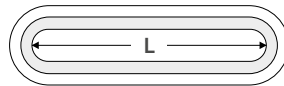

### CODES AND DIMENSIONS

CODE	L	width	WLL			pcs
			I	U	Ø	
	[cm] [in]	[cm] [in]	[kg] [lbs]	[kg] [lbs]	[kg] [lbs]	
MNT80050	50 19 3/4	3,5 1 3/8	800 1750	1600 3550	640 1400	100
MNT800100	100 39 3/8	3,5 1 3/8	800 1750	1600 3550	640 1400	100
MNT125050	50 19 3/4	5 2	1250 2750	2500 5500	1000 2200	100
MNT1250100	100 39 3/8	5 2	1250 2750	2500 5500	1000 2200	100

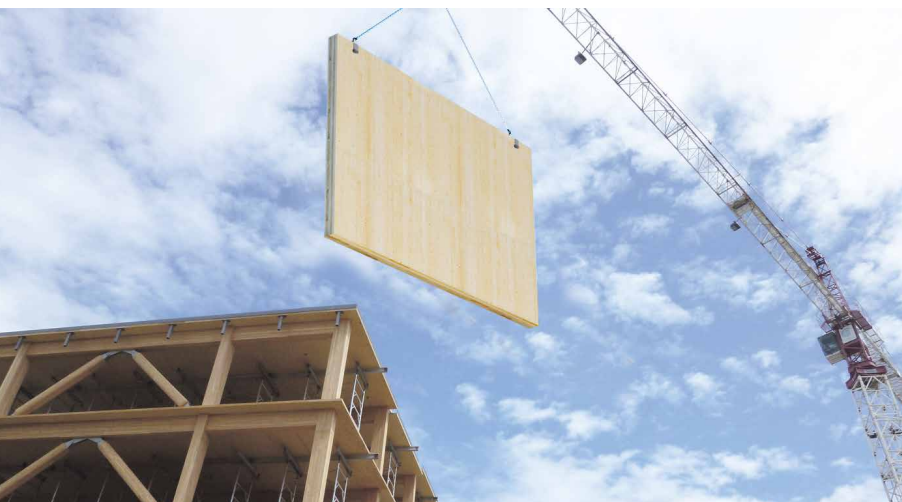

### MATERIAL

Polyester belts and labels according to EN 1492-1. 100% recyclable.

### FIELDS OF USE

Suitable for lifting and positioning wall, floor and beam elements.

# Integrated lifting for exposed CLT floor structures

**Invisible lifting system**, designed for floor structure elements with aesthetic requirements.

By combining a smooth dowel with the MANTIS transport strap, certified for lifting, a simple and sturdy transport system can be developed during the production of timber elements.

By drilling only two holes, which can be integrated in the woodworking process with a CNC machine, an invisible transport option can be created.

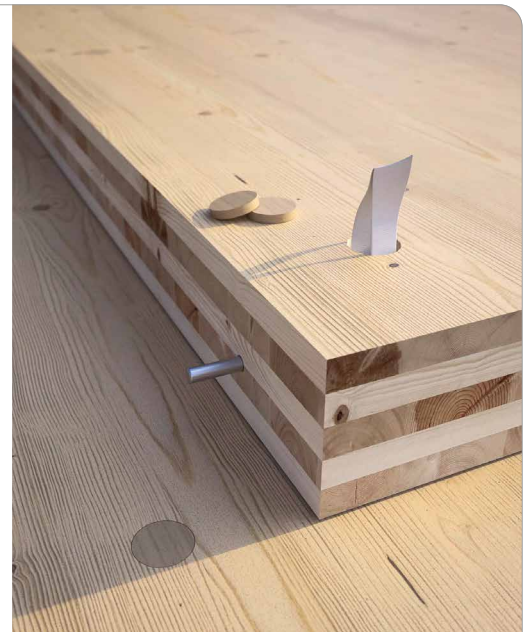

MANUALS

## MANTIS + STA for CLT FLOORS

### MANTIS + STA INSTALLATION

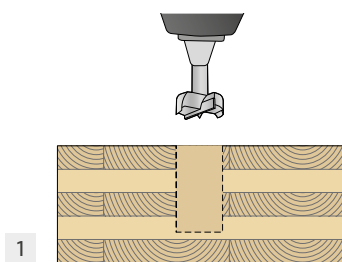

1 Drill the upper blind hole

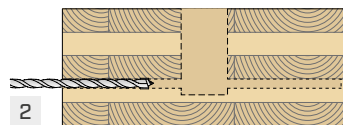

2 Side drilling for smooth dowel

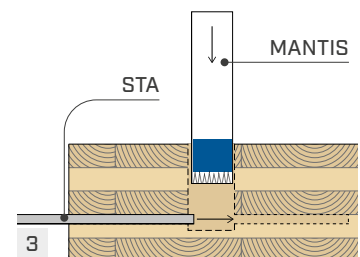

3 Insert STA dowel and MANTIS

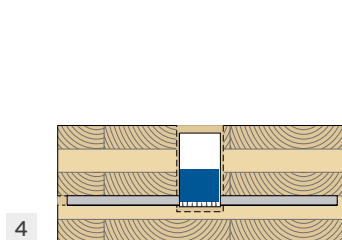

4 During the storage or transport of elements, MANTIS can remain protected in the hole

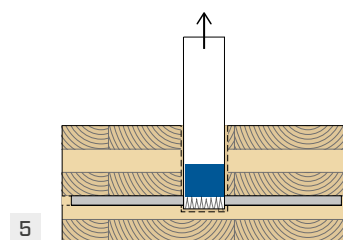

5 Lift MANTIS

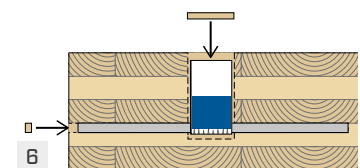

6 After lifting operations, both the blind hole and the side hole can be closed using TAPS

### RELATED PRODUCTS



TAPS

page 268



BORMAX 3.0 HM

page 244



LEWIS

page 236



STA

The complete technical data sheet is available at [www.rothoblaas.com](http://www.rothoblaas.com)



[rothoblaas.com](http://rothoblaas.com)

